

**M860: Trolley and stretcher – Separable  
User Manual**

## **M860: Trolley / Stretcher - Separable**

The trolley/stretcher, or M860, is an equipment with separable stretcher of manual drive. This equipment as for main purpose the transport of patients with mobility difficulties and post-operation condition. This product is developed and produced by Auto Ribeiro Lda.

### **Equipment's Overview**



### **Equipment's Lateral view**





### **Top view of Equipment**





### **CHARACTERISTICS:**

- Weight: 32,7 kg (trolley) + 18 kg (stretcher)
- Maximum load capacity: 250kg
- Trolley dimensions (closed): 1846 x 560 x 455 mm
- Trolley dimensions (open): 1846 x 560 x 870 mm
- Dimensions (stretcher): 1915 x 568 x 365 mm

## FRONT LEG CONTROL (In mid position)

<b><u>Security System</u></b>	
	1° - Lift the lever (in the right side of trolley)
	Final Position

## WHEELS

<b><u>Swivel Wheels</u></b>	
	2 Swivel wheels
<b><u>Fixed Wheels</u></b>	
	2 Fixed wheels
	<b><i>Block of fixed wheels</i></b> 1° - Engage the tabs with the foot to lock the wheels.

## BACK LEGS CONTROL

### Security System



1° - Press the left lever until it moves and keep it pressed.

Note: To put the back leg into halfway, just press the lever and release it immediately.

## FRONT LEG CONTROL

### Security System

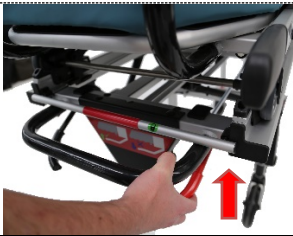

1° - Press the right lever until it moves and keep it pressed

## STRETCHER BLOCK SYSTEM CONTROL

### Security system



1° - Press the lever and keep it pressed

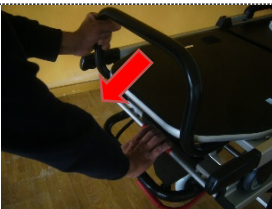

2° - Press the stretcher to release the trolley.

## TELESCOPIC HANDLES

### Security System

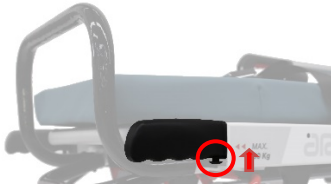

1° - Press the button



2° - Push or pull the wrist to fit the desired length

## SWING DOWN SIDEARMS

### Security System



1° - Press the red button in the sidearm



2° - Push or pull to achieved the desired opening position.

## ADJUSTABLE BACKREST

The backrest can be adjusted in different positions:

### Supine position



### Semi-fowler's Position and Fowler Position

- 1° - Press the red lever
- 2° - Push or pull the backrest



## ADJUSTABLE FEET POSITION

Adjustable feet in three different positions:

### Footrest and Knees-Flex Position



### Lower Legs part Elevation (16° degrees)

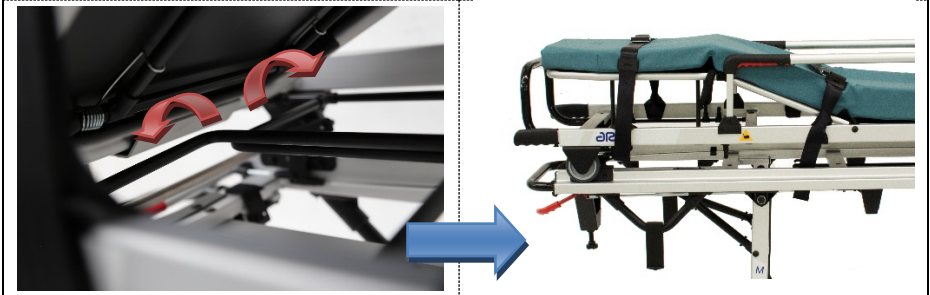

### Legs Elevation





## SAFETY WARNINGS



 **This Equipment can be dangerous:**

- Risk of entrapment

**ATTENTION: USE WITH CAUTION!**



- Risk of entrapment

## MAINTENANCE



- Perform visual inspection every fifty cycles of utilization.
- Lubrication elements of mechanical function every six months with high viscosity lubricant
- Checking of tightness of binding elements of every three months. Proceed to adjust if necessary

## ACCESSORIES

### Fixing Restrain Straps



Shoulder Harness restraints



Legs and feet restrains

### Restraint Installation



1° - Tie restraint straps in inner bars.



2° - Pass the top restraints through the plate slots



3° - Join belt buckles

## ACCESSORIES

### IV pole



IV pole.

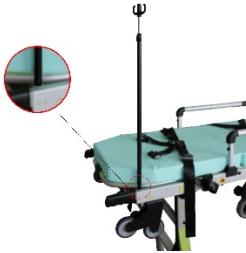

IV pole in use.

### Instruments Tray



Instruments tray.



Instruments tray in use.

## ACCESSORIES

### Headrest



1° - Pass the strap through the plate slots



2° - Join both sides of the velcro



Rua de S. Caetano, 551 Apartado 526  
4411-701 Canelas; Vila Nova de Gaia, Portugal

Telf: +351 227157100 , Fax: +351 2271244

[comercial@arequipment.pt](mailto:comercial@arequipment.pt)

[www.arequipment.com](http://www.arequipment.com)

## **BASED ON STANDARDS**

<b>EN 1865-1:2010</b>	Patient handling equipment used in road ambulance.  -Specification for general stretcher systems and patient handling equipment.
<b>EN 1789:2007+A1:2010</b>	Medical vehicles and their equipment – Road Ambulances
<b>ISO 14971:2007</b>	Medical devices – Application of risk management to medical devices.
<b>EN ISO 9001:2008</b>	System of quality management

